

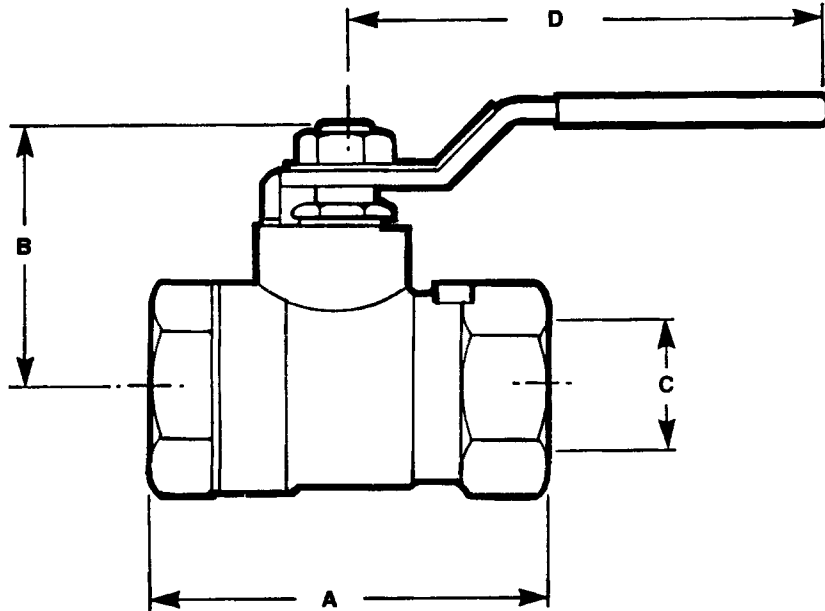

BALL TYPE SHUT-OFF VALVES



- FOR USE WITH:**
- Sprinkler Systems
 - Dry Sprinkler Systems
 - Standpipe Systems
 - Manual Deluge Control Valve

REGULARLY FURNISHED: Forged brass body. Cadmium plated vinyl insulated handle. Chrome-plated brass ball with nylon seat.

FIG. NO.	SIZE	A	B	C	D	PRESSURE RATING P.S.I.
4405	1/2 *	2 3/16	1 3/8	.472	3 1/16	600
4407	3/4 *	2 1/2	1 3/4	.672	3 13/16	600
4410	1 *	3	1 7/8	.891	3 13/16	500
4412	1 1/4 *	3 7/16	2 1/16	1.109	3 13/16	500
4415	1 1/2 *	3 3/4	2 3/8	1.378	4 13/16	500
4420	2 *	4 3/8	2 11/16	1.772	4 13/16	500
4425	2 1/2	5 3/4	3 1/4	2.250	6	400
4430	3	6 1/4	3 1/2	2.625	6	400

ALL DIMENSIONS IN INCHES

DIMENSIONS ARE SUBJECT TO MANUFACTURERS TOLERANCE AND CHANGE WITHOUT NOTICE. WE ASSUME NO RESPONSIBILITY FOR USE OF SUPERSEDED OR VOID DATA.

DATE
3-1-86

FIGURE NUMBER

4400 SERIES