

## SERIES 2887-2898 FIRE HOSE STORAGE DEVICES

### HOSE STORAGE RACK

#### SPECIFICATIONS

Non-Automatic steel pin type hose rack with red glossy polyester finish for use with 2-1/2" polyflex hose and nipple mounting.

#### MODEL SELECTION

☐ 2887 Nipple Mounted

#### PRODUCT OPTIONS

##### OPTIONS:

- ☐ -E Wall Bracket  
☐ -G Pipe Bracket (Specify pipe size \_\_\_\_\_)



MODEL 2887 (Shown)

### COLUMN MOUNTED

#### SPECIFICATIONS

Hose holder constructed of 12 gauge steel with red polyester finish. Mounting brackets supplied for attaching to either side of an 8" through 12" "I" beam. Maximum capacity is 100' - 1-1/2" S.J. hose.

#### MODEL DIMENSIONS

Width - 16"  
 Height - 10"  
 Depth - 9"

#### MODEL SELECTION

☐ 2888 Column Mounted



MODEL 2888 (Shown)

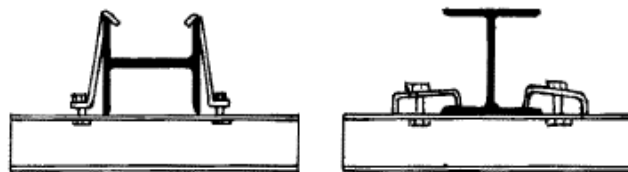

### HOSE HANGER

#### SPECIFICATIONS

Wall mounted hose hanger with red glossy polyester finish for use with 1-1/2" or 2-1/2" collapsible hose and nipple mounting.

#### MODEL SELECTION

☐ 2889 Wall Mounted

#### PRODUCT OPTIONS

##### OPTIONS:

- ☐ -E Wall Bracket  
☐ -G Pipe Bracket (Specify pipe size \_\_\_\_\_)

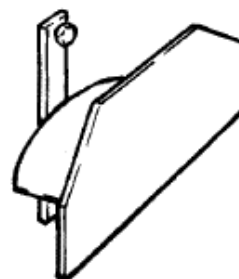

MODEL 2889 (Shown)

Call Potter Roemer - Fire Pro for current listings and approvals. Dimensions are subject to manufacturer's tolerance and may change without notice. Potter Roemer - Fire Pro assumes no responsibility for use of void or superceded data. © Copyright Potter Roemer - Fire Pro, Member of Morris Group International™ Please visit [potterroemer.com](http://potterroemer.com) for most current specifications.

**2887-2898 SERIES** Date: 10/17/24

**MEMBERSHIP**



FIRE EQUIPMENT  
MANUFACTURERS'  
ASSOCIATION



#### POTTER ROEMER

Headquarters:  
 P.O. Box 3527  
 City of Industry, CA  
 91744 U.S.A.  
 Los Angeles Area  
 800-366-3473  
 626-855-4890

Also in:  
 New York (800) 526-4592  
 Chicago (800) 547-3473  
 Atlanta (800) 762-0542  
 Miami (833) 744-3473  
 Dallas (866) 644-3473

[www.potterroemer.com](http://www.potterroemer.com)

## SERIES 2887-2898 FIRE HOSE STORAGE DEVICES

### HUMP TYPE RACK

#### SPECIFICATIONS

Solid sides, steel construction with red glossy polyester finish and identification decal. Wall brackets permit a full 180° swing.

#### MODEL SELECTION

- ☐ 2890
- ☐ 2890-2

#### DIMENSION CHART

Model No.	A	B	MAXIMUM HOSE CAPACITY		
			ft.	in.	Hose Type
2890	24	16	100	1 1/2	2915 Polyflex
			100	1 1/2	2901 Single Jacket
			75	1 1/2	2911 Double Jacket
2890-2	28	24	100	1 1/2	2911 Double Jacket

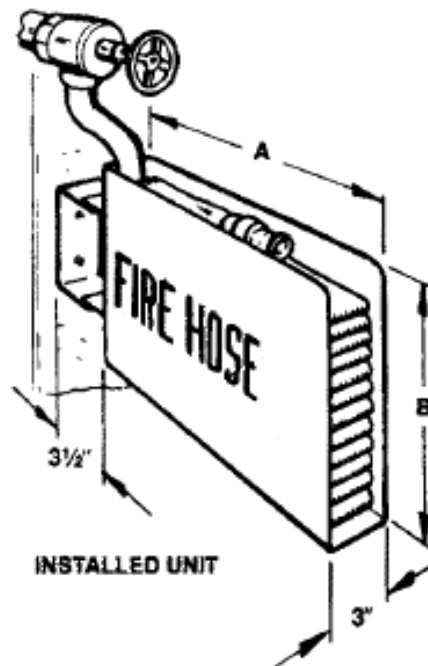

#### HOSE RACK & REEL COVERS:

- ☐ 2892 For 75 ft. Polyflex Rack
- ☐ 2893 For 100 ft. Polyflex Rack
- ☐ 2894 For 100 ft. Superflex Rack
- ☐ 2895 For 2876 Hose Reel
- ☐ 2893 For 2877-2878 Hose Reel
- ☐ 2894 For 2879 Hose Reel



Call Potter Roemer - Fire Pro for current listings and approvals. Dimensions are subject to manufacturer's tolerance and may change without notice. Potter Roemer - Fire Pro assumes no responsibility for use of void or superceded data. © Copyright Potter Roemer - Fire Pro, Member of Morris Group International™ Please visit [potterroemer.com](http://potterroemer.com) for most current specifications.

#### 2887-2898 SERIES

MEMBERSHIP



FIRE EQUIPMENT  
MANUFACTURERS'  
ASSOCIATION



CASPE  
American Society of  
Plumbing Engineers

NFSA  
NATIONAL FIRE SPRINKLER ASSOCIATION, INC.



#### POTTER ROEMER

Headquarters:  
P.O. Box 3527  
City of Industry, CA  
91744 U.S.A.  
Los Angeles Area  
800-366-3473  
626-855-4890

Also in:  
New York (800) 526-4592  
Chicago (800) 547-3473  
Atlanta (833) 744-0542  
Miami (833) 744-3473  
Dallas (866) 644-3473

[www.potterroemer.com](http://www.potterroemer.com)

## SERIES 2887-2898 FIRE HOSE STORAGE DEVICES

### SPECIFICATIONS

12 ga. steel, red polyester coated, upper hanger, spring loaded. Hanger accommodates a maximum of 100'/30.4m, 1-1/2"/3.8cm or 2-1/2"/6.4cm hose.

### MODEL SELECTION

☐ 2891

### HANGER SPACING CHART

NUMBER LOOPS	50 FT	HOSE LENGTH 75 FT	100 FT
2	12 FT	-	-
3	8 FT	12 FT	-
4	6 FT	9 FT	12 FT

### COLUMN HANGER TYPE RACK

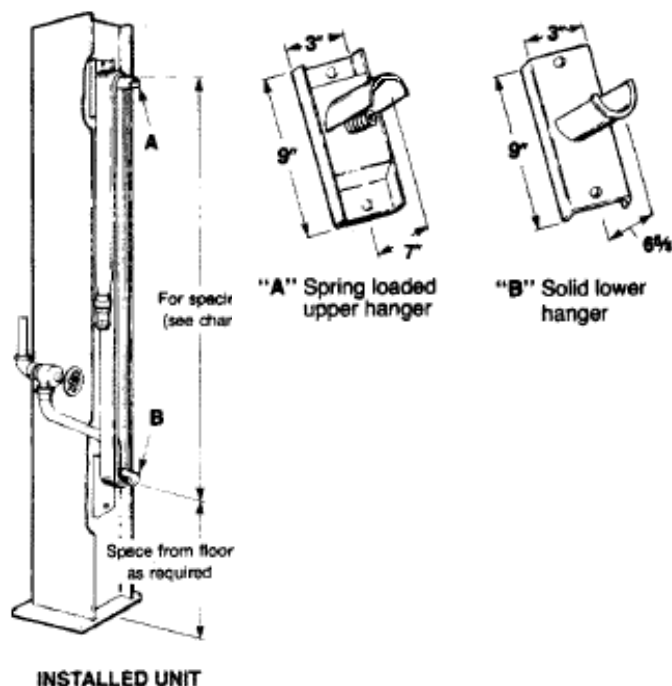

### SELECT EQUIPMENT

#### HOSE LENGTH:

☐ 50' ☐ 75' ☐ 100'

#### HOSE BRASS PINLUG COUPLED

- ☐ 2901 1-1/2" Single Jacket Lined 300 lb. Test
- ☐ 2902 2-1/2" Single Jacket Lined 300 lb. Test
- ☐ 2911 1-1/2" Double Jacket Lined 600 lb. Test
- ☐ 2914 2-1/2" Double Jacket Lined 600 lb. Test
- ☐ 2915 1-1/2" Single Jacket Lined 500 lb. Test Polyflex
- ☐ 2916 2-1/2" Single Jacket Lined 500 lb. Test Polyflex
- ☐ 2926 1-1/2" Single Jacket Lined 500 lb. Test Superflex
- ☐ 2929 2-1/2" Single Jacket Lined 500 lb. Test Superflex
- ☐ Other - Specify

#### OPTION:

☐ U/L Label

#### THREADS:

☐ N.S.T. ☐ Other - Specify

#### NOZZLES

- ☐ 2945 1-1/2" Plain Plastic
- ☐ 2947 1-1/2" Plain Brass
- ☐ 2948 2-1/2" Plain Brass (2891 Only)
- ☐ 2960 1-1/2" Red Lexan Fog
- ☐ 2962 1-1/2" Brass Fog U/L
- ☐ 2972 1-1/2" Brass Fog with Rubber Bumper U/L
- ☐ 2973 2-1/2" Brass Fog with Rubber Bumper U/L
- ☐ 2980 1-1/2" Red Lexan All Fog
- ☐ 2985 1-1/2" Brass All Fog U/L

#### VALVE

- ☐ 4060 1-1/2" Female x Male Brass Angle U/L and ◀FM▶
- ☐ 4065 2-1/2" Female x Male Brass Angle U/L and ◀FM▶
- ☐ 4080 1-1/2" Female x Male Brass Angle Pressure Restricting U/L
- ☐ 4085 2-1/2" Female x Male Brass Angle Pressure Restricting U/L
- ☐ Other - Specify

Call Potter Roemer - Fire Pro for current listings and approvals. Dimensions are subject to manufacturer's tolerance and may change without notice. Potter Roemer - Fire Pro assumes no responsibility for use of void or superseded data. © Copyright Potter Roemer - Fire Pro, Member of Morris Group International™ Please visit [potterroemer.com](http://potterroemer.com) for most current specifications.

### 2887-2898 SERIES

MEMBERSHIP



### POTTER ROEMER

Headquarters:  
P.O. Box 3527  
City of Industry, CA  
91744 U.S.A.  
Los Angeles Area  
800-366-3473  
626-855-4890

Also in:  
New York (800) 526-4592  
Chicago (800) 547-3473  
Atlanta (833) 744-0542  
Miami (833) 744-3473  
Dallas (866) 644-3473

[www.potterroemer.com](http://www.potterroemer.com)