

SERIES 4060-4065 MALE ANGLE HOSE VALVES

For Use as a Fire Department Valve or Fire Pump Test Valve

FEMALE X MALE

Cast brass valve with red hand wheel, Female N.P.T. inlet x male hose thread outlet. 300 psi

*4060-P and 4065-P have a silver hand wheel

MODEL SELECTION

VALVES

- ☐ **4060** 1-1/2" Female x Male Angle Valve ◀FM▶
- ☐ **4060-EV** 1-1/2" Female x Male Angle Valve ◀FM▶
Buy American
- ☐ **4060-P** 1-1/2" Female x Male Angle Valve ◀FM▶
Domestic Manufactured
- ☐ **4065** 2-1/2" Female x Male Angle Valve ◀FM▶
- ☐ **4065-EV** 2-1/2" Female x Male Angle Valve ◀FM▶
Buy American
- ☐ **4065-P** 2-1/2" Female x Male Angle Valve ◀FM▶
Domestic Manufactured
- ☐ **4065-500** 2-1/2" Female x Male Angle Valve 500 psi rated
Buy American

OPTIONAL CAPS & FLANGES

- ☐ **4615** 1-1/2" Cap w/ Chain
- ☐ **4625** 2-1/2" Cap w/ Chain
- ☐ **4711** 1-1/2" Flange 3" O.D.
- ☐ **4712** 2-1/2" Flange 6-1/4" O.D.



MODEL 4065-EV (Shown)

PRODUCT OPTIONS

FINISHES:

- ☐ -B Polished Brass
- ☐ -C Rough Chrome Plated
- ☐ -D Polished Chrome Plated

THREADS:

- ☐ N.S.T.
- ☐ Other _____

VARIATIONS:

- ☐ Extended Stem Up to 24"
Specify _____
- ☐ Rocker Lugs (Cap Models Only)
- ☐ -GRV Grooved Inlet (4065 Only)

Call Potter Roemer - Fire Pro for current listings and approvals. Dimensions are subject to manufacturer's tolerance and may change without notice. Potter Roemer - Fire Pro assumes no responsibility for use of void or superseded data. © Copyright Potter Roemer - Fire Pro, Member of Morris Group International™ Please visit potterroemer.com for most current specifications.

4060-4065 SERIES Date: 01/07/24

MEMBERSHIP



FIRE EQUIPMENT
MANUFACTURERS'
ASSOCIATION



ONFSA
NATIONAL FIRE SPRINKLER ASSOCIATION, INC.



POTTER ROEMER

Headquarters:
P.O. Box 3527
City of Industry, CA
91744 U.S.A.
Los Angeles Area
800-366-3473
626-855-4890

Also in:
New York (800) 526-4592
Chicago (800) 547-3473
Atlanta (800) 762-0542
Miami (833) 744-3473
Dallas (866) 644-3473

www.potterroemer.com

SERIES 4060-4065 MALE ANGLE HOSE VALVES

MODEL DIMENSIONS

Model	Size	A	B-Closed	B-Open	C	D
4060	1-1/2"	4"	6-5/16"	7-5/8"	2-7/16"	2"
4060-EV	1-1/2"	4-1/32"	6-1/2"	7-1/2"	2-1/4"	1-7/8"
4060-P	1-1/2"	3-3/4"	6-3/4"	7-3/4"	2-1/2"	1-13/16"
4065	2-1/2"	5"	8-1/2"	10 7/16"	2-5/8"	2-3/4"
4065-EV	2-1/2"	5-1/8"	8-29/32"	10-1/2"	3-3/16"	2-5/8"
4065-EV-GRV	2-1/2"	5-1/8"	9-25/32"	11-1/2"	3-3/16"	3-9/16"
4065-P	2-1/2"	5"	9"	10-13/16"	3-3/16"	2-19/32"
4065-P-GRV	2-1/2"	5"	10"	11-13/16"	3-3/16"	3-19/32"
4065-500	2-1/2"	5-1/8"	8-29/32"	10-1/2"	3-3/16"	3-1/16"

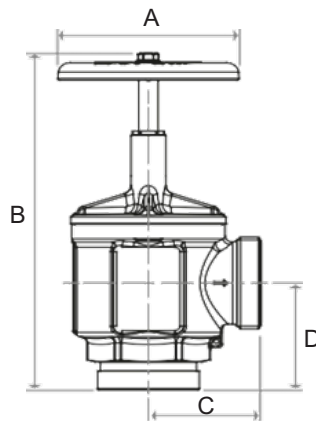
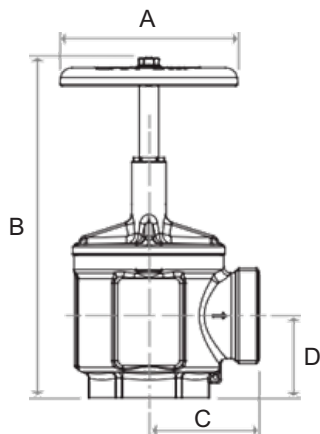

Call Potter Roemer - Fire Pro for current listings and approvals. Dimensions are subject to manufacturer's tolerance and may change without notice. Potter Roemer - Fire Pro assumes no responsibility for use of void or superseded data. © Copyright Potter Roemer - Fire Pro, Member of Morris Group International™ Please visit potterroemer.com for most current specifications.

4060-4065 SERIES

MEMBERSHIP



FIRE EQUIPMENT
MANUFACTURERS'
ASSOCIATION



ONFSA
NATIONAL FIRE SPRINKLER ASSOCIATION, INC.



POTTER ROEMER

Headquarters:
P.O. Box 3527
City of Industry, CA
91744 U.S.A.
Los Angeles Area
800-366-3473
626-855-4890

Also in:
New York (800) 526-4592
Chicago (800) 547-3473
Atlanta (800) 762-0542
Miami (833) 744-3473
Dallas (866) 644-3473

www.potterroemer.com