

SPECIFICATIONS

Potter Roemer/ Fire Pro® fog nozzles comply with all aspects of U.S. Forest Service specifications. Twist shutoff fog tips are machined from high strength 6061 T-6 aluminum bar stock and have a hard anodized finish. 1" tip features dual gallonage with 10 GPM on the low setting in straight through narrow fog and in the high range from straight stream through wide angle fog. Ideal for "mop up" or to conserve water in the low range.



FP1023T (Shown)

REGULARLY FURNISHED

- Combination fog and straight stream
- Lightweight/strong aluminum
- Hard anodized finish - red

MODEL	INLET In (mm)	WEIGHT Lbs (kg)	GPM (lpm)
FP1023T	1" (25)	2/3 (0.3)	10-23 (38-87)
FP1040T	1" (25)	2/3 (0.3)	10-40 (38-51)

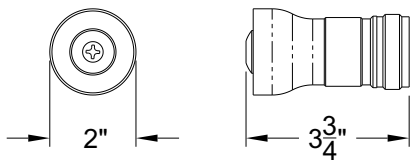

FP1023T

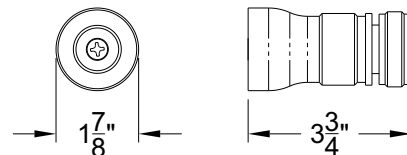

FP1040T

WARNING: Cancer and Reproductive Harm - www.P65Warnings.ca.gov

Call Potter Roemer - Fire Pro for current listings and approvals. Dimensions are subject to manufacture's tolerance and may change without notice. Potter Roemer - Fire Pro assumes no responsibility for use of void or superceded data. Please visit potterroemer.com for most current specifications

FT-FP1023T

Revised: 09/05/18

MEMBERSHIP



FIRE EQUIPMENT
MANUFACTURERS'
ASSOCIATION



POTTER ROEMER/FIRE PRO

Headquarters:
P.O. Box 3527
City of Industry, CA
91744 U.S.A.
Los Angeles Area
800-366-3473
626-855-4890

Also in:
New York (800) 526-4592
Chicago (800) 547-3473
Atlanta (800) 762-0542
Miami (866) 961-3473
Dallas (866) 644-3473

www.potterroemer.com